



SKYPAK

Heating & Cooling
Self Contained Packages

Replacement for
"Fedders Vertipak &
Mueller Climatrol"

SKYPAK gives you a complete air-conditioning and heating system as an all-in-one package unit.

Designed for conventional through-the-wall installation in residential low and high rise, industrial and commercial applications. The all-indoor design eliminates the need for any unsightly exterior equipment, and refrigerant line connections, while maintaining architectural esthetics, protecting the Skypak from weathering and vandalism.

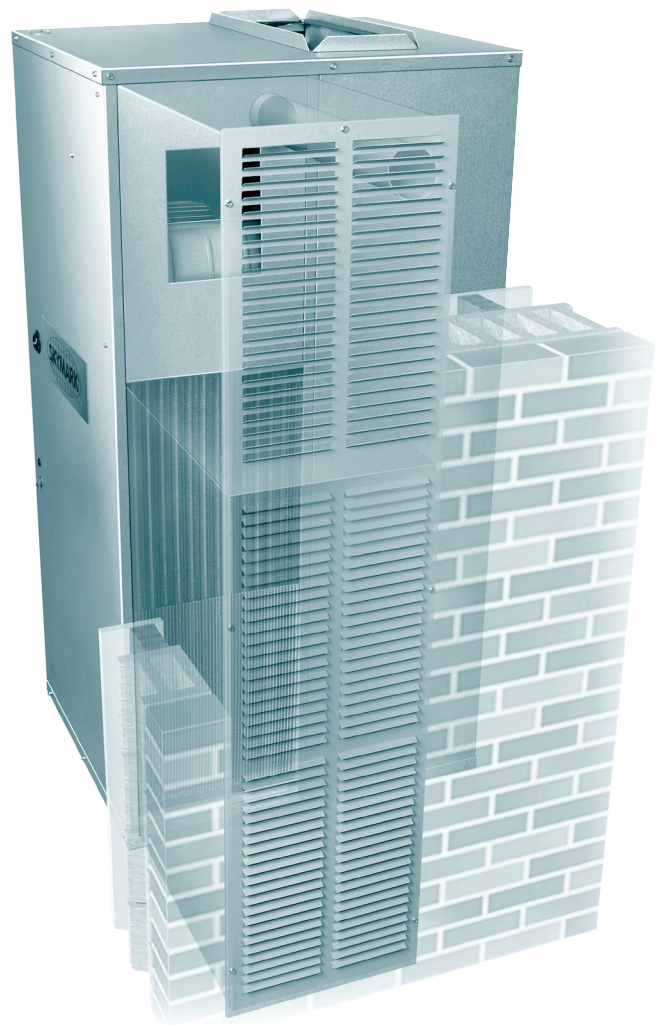

SKYPAK Features and Data

- Available in natural gas (direct vent), or electric heating.
- Gas input ratings of 40,000, and 60,000 BTUH.
- Cooling capacity from 18,600 to 24,400 BTUH.
- R-410A refrigerant.
- Every unit rigorously factory tested for quality control.
- Allows independent metering and temperature control, eliminating building wide service shut downs as encountered with conventional systems.
- Aluminized steel tubular heat exchanger provides 80.3% AFUE.
- Return air can be ducted if required.
- Power vented through wall sleeve, eliminating chimney.
- High efficiency scroll compressor.
- Convenient indoor access to all parts and service needs, eliminating bulky chassis removal and spares.
- Condensate drain isolated from air stream.

All components readily available through authorized stocking distributors.

GAS AND ELECTRIC HEATING AND COOLING

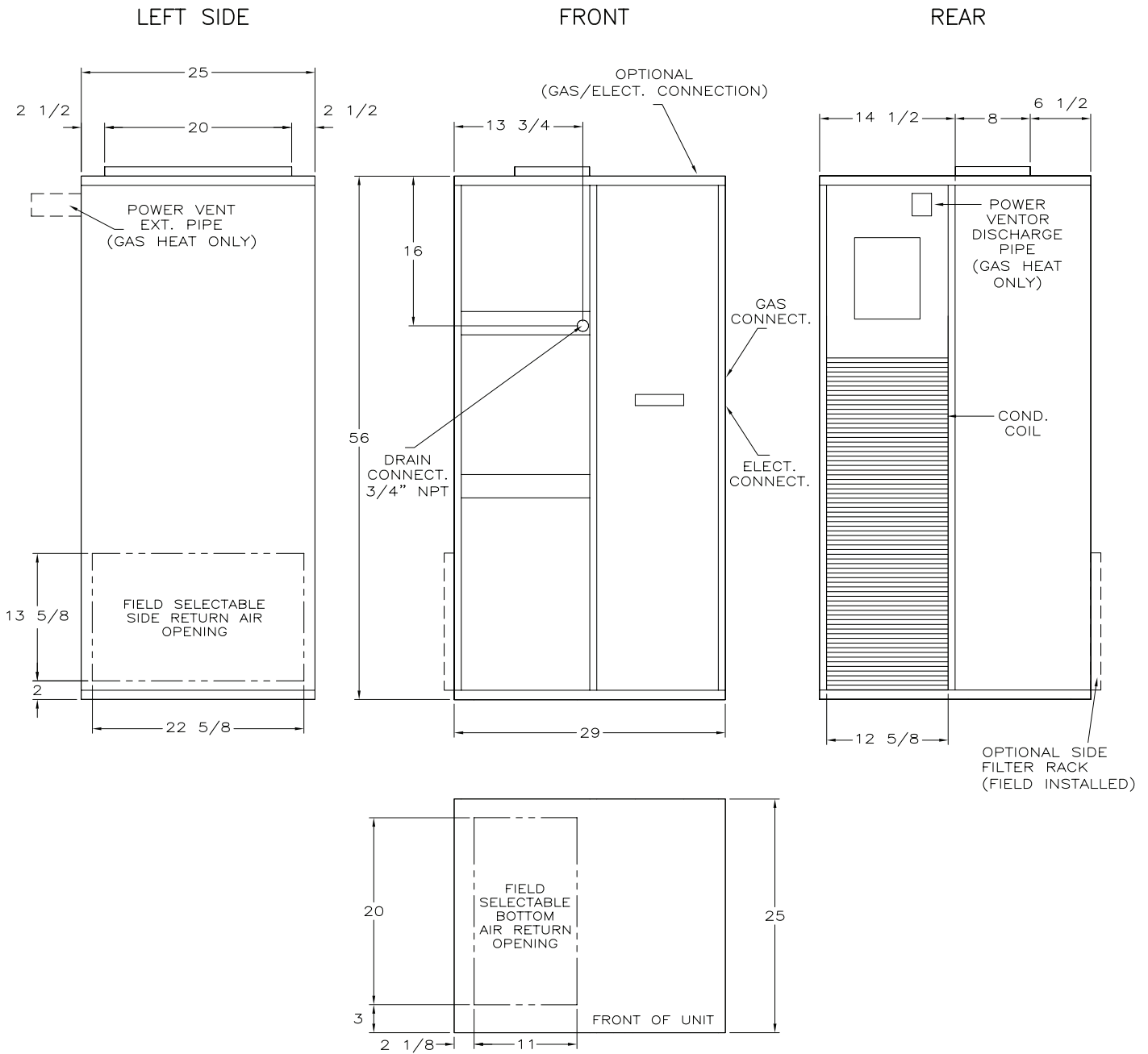

APPLIES TO ALL SKYPAK UNITS

MINIMUM CLEARANCES – FROM COMBUSTIBLE MATERIALS

TOP	SIDES	BACK	FRONT
0"	0"	0"	1"

For Installation on combustible flooring
 For Installation in an alcove or closet
 Minimum clearance for service access – 24" to front of unit

APPLIES TO GAS HEAT UNIT ONLY

IMPORTANT: POWER VENTOR DISCHARGE PIPE MUST TERMINATE 1"-1 1/4" FROM EXTERIOR GRILLE/LOUVRE.

MINIMUM CLEARANCES – FROM COMBUSTIBLE MATERIALS

FLUE
10"



GAS AND ELECTRIC HEATING UNIT DATA

GAS HEATING UNIT DATA

<i>Model</i>	<i>RGAD401812</i>	<i>RGAD601812</i>	<i>RGAD402412</i>	<i>RGAD602412</i>
Heating Section				
208-230 / 1 / 60				
Rated Input-BTU / HR	40,000	60,000	40,000	60,000
Output Capacity-BTU / HR	32,320	48,480	32,320	48,480
CFM (Fan Speed)	600 (MED)	675 (HI)	575 (LO)	750 (MED)
AFUE	80.30%	80.30%	80.30%	80.30%
Cooling Section				
208-230 / 1 / 60 197 min. Oper. VOLTS				
BTU / HR T. C*	18,000		24,400	
BTU / HR Sensible	13,800		19,400	
CFM At .30" E.S.P.	600		800	
Efficiency (S.E.E.R.)	11.5		11.0	
Compressor R.L.A.	10.0		14.1	
Compressor L.R.A.	48.0		58.3	
Min. Circuit Ampacity	14.8		20.63	
Max. Fuse / CCT. BKR.	20		30	
Filter Size / Type**	24" x 34" / 1" Thick Replaceable Media			
Approx. Ship Weight (LBS.)	325	330	340	345

ELECTRIC HEATING UNIT DATA

<i>Model</i>	<i>READ051812</i>	<i>READ751812</i>	<i>READ101812</i>	<i>READ052412</i>	<i>READ752412</i>	<i>READ102412</i>	<i>READ152412</i>
Heating Section							
KW Total 208 / 230	4.20 / 5.14	6.30 / 7.71	8.41 / 10.28	4.20 / 5.14	6.30 / 7.71	8.41 / 10.28	12.61 / 15.42
No. of Elements	1	2	2	1	2	2	3
CFM @ .25" ESP	615 (MED)	615 (MED)	615 (MED)	700 (LO)	700 (LO)	840 (MED)	840 (MED)
Heating Output MBTU / HR	14.3 / 17.5	21.5 / 26.3	28.7 / 35.1	14.3 / 17.5	21.5 / 26.3	28.7 / 35.1	43.0 / 52.6
Cooling Section							
208-230 / 1 / 60 197 min. Oper. VOLTS							
BTU / HR T. C*	18,000			24,400			
BTU / HR Sensible	13,800			19,400			
CFM At .30" E.S.P.	600			800			
Efficiency (S.E.E.R.)	11.5			11.0			
Compressor R.L.A.	10.0			14.1			
Compressor L.R.A.	48.0			58.3			
Min. Circuit Ampacity 208V	26.8	39.42	52.10	26.8	39.8	52.48	77.78
Max. Fuse / CCT. BKR. 208V	30	40	60	30	40	60	80
Min. Circuit Ampacity 230V	29.43	43.40	57.37	29.43	43.78	57.74	85.68
Max. Fuse / CCT. BKR. 230V	30	45	60	30	45	60	90
Filter Size / Type**	24" x 34" / 1" Thick Replaceable Media						
Approx. Ship Weight (LBS.)	290	295	300	305	310	315	320

Caution: Cooling section of this unit should not be operated when outside temperature is below 60°F

Performance tested in accordance with ARI standard 210/240-03, and rating conditions of 95°F outdoor ambient, and 80°F D.B./67°F W.B. indoor air temperature.

* T.C. = net cooling capacity (Heat dissipation from fan motor included).

** Factory Supplied.

As SKYMARK maintains a continuous product improvement policy, specifications are subject to change without notice.

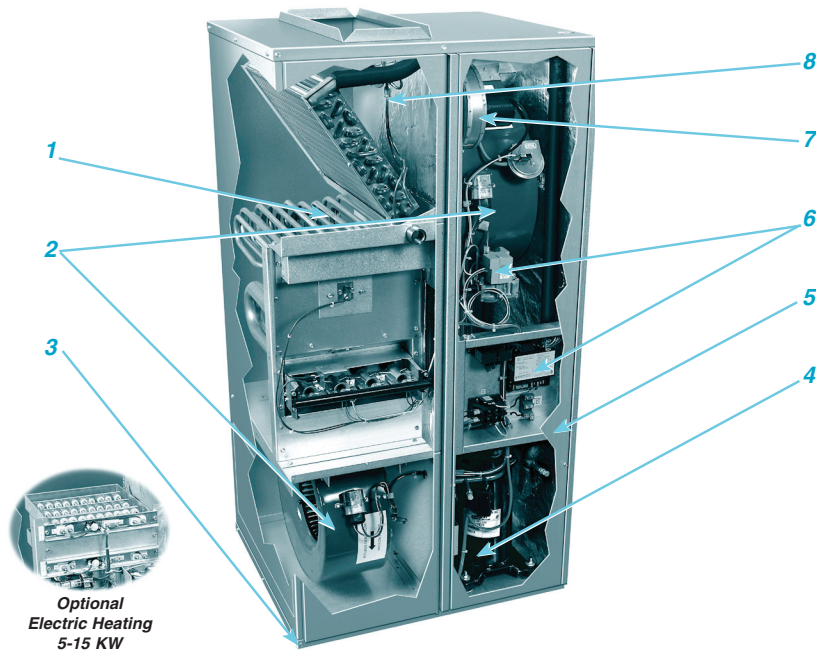

KEY COMPONENTS

- 1 - Primary and secondary aluminized steel tubular heat exchanger.
- 2 - Centrifugal evaporator and condenser blowers, zinc coated wheels and painted housing for rust resistance.
- 3 - Ductable return air from left side; ductable bottom or front of unit with optional return air plenum.
- 4 - High efficiency compressor.
- 5 - Heavy gauge galvanized insulated cabinet.
- 6 - Honeywell "smart" valve c/w hot surface igniter.
- 7 - Power ventor.
- 8 - Thermal Expansion valve.

SKYMARK MODEL # NOMENCLATURE CODE

Model#	RGAD	60	24	12	C
	Product Type				
	RGAD = SKYPAK 'RETROFIT' SERIES - GAS HEAT READ = SKYPAK 'RETROFIT' SERIES - ELECTRIC HEAT				
	Nominal Heating Capacity				
	RGAD40 = 40MBH INPUT RGAD60 = 60MBH INPUT READ05 = 5 Kw READ75 = 7.5 Kw READ10 = 10 Kw READ15 = 15 Kw				
				Voltage	
				12 = 208-230/1/60	
			Nominal Cooling Capacity		
			18 = 1.5 TONS 24 = 2.0 TONS		
				Convertible Return	
			FIELD SELECTED BOTTOM OR SIDE		



SkyMark maintains a continuous product improvement policy, therefore specifications are subject to change without notice.